

# INSTALLATION AND SERVICE MANUAL

**LIGMAN**  
NORTH AMERICA

For Installation of Odessa 11,12 Floodlights LED.  
Model. UOD-50131,UOD-50132,UOD-50141 and UOD-50143.

## Product drawing (dimensions)

IP66 IK08 CLASS I 0.3m

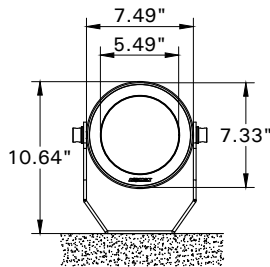

UOD-50131,UOD-50132

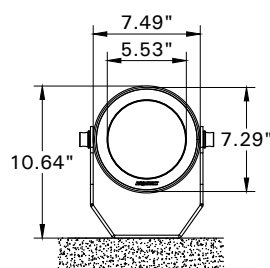
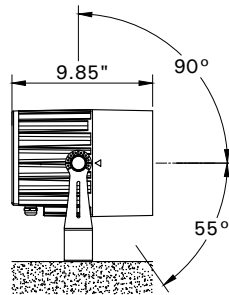

UOD-50141,UOD-50143

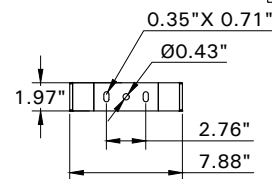
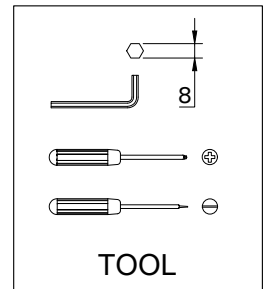
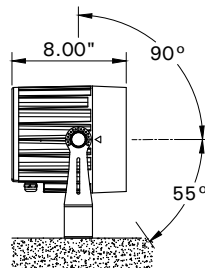

**MOUNTING DETAIL**  
Max.mounting height 7m.

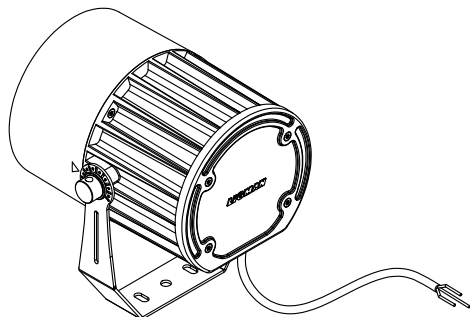

1

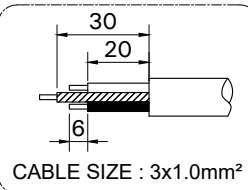

3

Cable OD  
Min. 6mm.  
Max. 10mm.

2

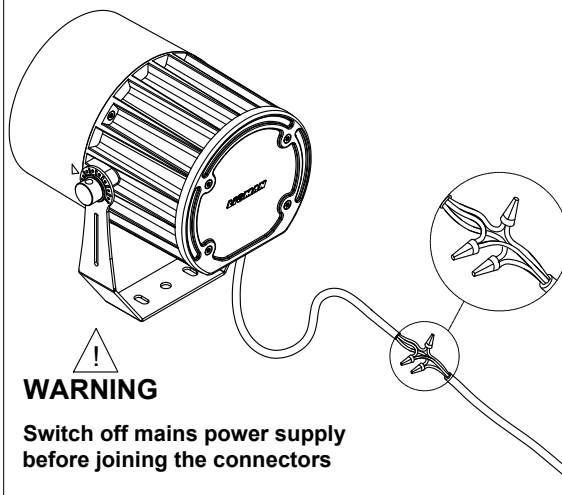

**WARNING**

Switch off mains power supply  
before joining the connectors

- LIGMAN standard products are supplied with the control gear 24Vdc.  
The control gear for other voltages and frequencies is available upon request, please consult us for more details.
- LIGMAN luminaires are designed to conform IEC 60598 2-18 standard.  
Technical amendments and modifications techniques reserved.

**Ligman Lighting USA**

7144 NE Progress Court, Hillsboro  
Oregon, 97124, USA  
Tel : 503 645 0500 | Fax : 503 645 8100

④

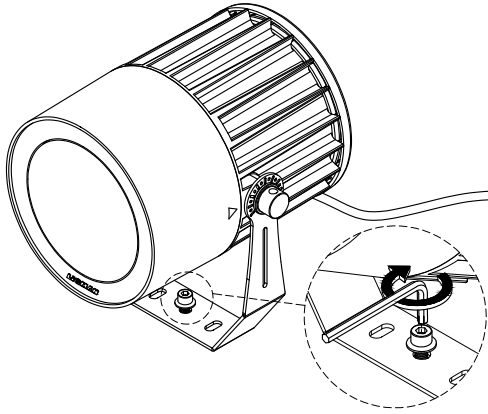

Torque :21.0Nm.

⑤

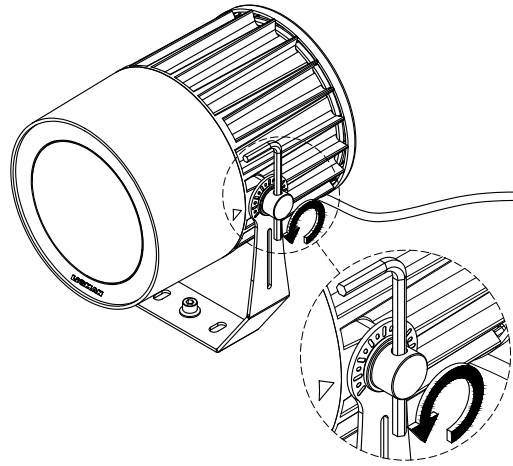

⑥

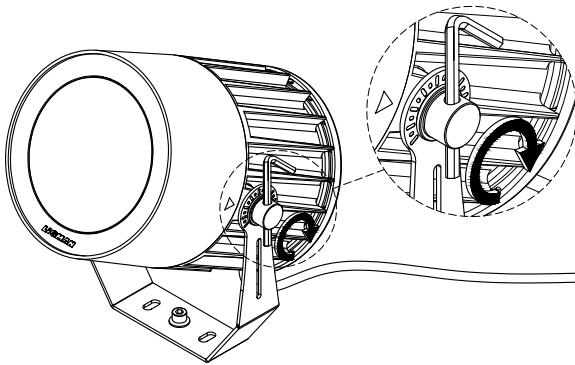

Torque :36.5Nm.

⑦

